



REACH

EXTENDING GOD'S GRACE

AUTHENTIC RELATIONSHIPS | GENUINE COMMUNITY | REFLECTING CHRIST

All this is for your benefit, so that the grace that is reaching more and more people may cause thanksgiving to overflow to the glory of God.

- The Apostle Paul

GOD REACHING DOWN

Since the very beginning as a small group of faith-filled people to our growing, responsive congregation today, God has been reaching down to lift up Rush Creek Bible Church. For nearly 100 years, we have been on this path that God set before us—growing in faith, willingly loving, and actively serving others. We have prayerfully sought his direction every step of our journey to ensure we become the church He needs us to be in each precise moment, for both our congregation and our community. Today we continue on that path of spiritual growth and response.

US REACHING OUT

With church attendance dropping nationally and one-third of an entire generation not considering church relevant to their lives, our communities are becoming the new mission field. In fact, our community has always been our primary mission field, but today's shifting culture makes the needs increasingly clear.

We must intentionally invest and be present in our own community, to those inside and outside the walls of the church. We must actively introduce the unchanging message of Christ's love to unbelievers and the spiritually thirsty right here in our own backyard. We must reflect the light of the gospel in the midst of so much brokenness.



REACHING OUR COMMUNITY

God has used Rush Creek Bible Church in amazing ways to engage our community, including our cooperation with the public schools, the township, and area churches. By God's grace we have not simply been responsive to the needs, but an example to the community as to what active engagement and collaborative partnership looks like. Still, there is more we could do.

Our Byron Center community is the fastest growing area for families in West Michigan. Anticipating this growth presents amazing opportunities to witness for Christ—not just "doing" church but "being" church for life transformation.

None of us were created to do life alone. Each of us at Rush Creek Bible Church individually and collectively is called to extend his grace to those around us. We are resolved to nurture our families; coming alongside to equip, prepare, disciple, and provide a Biblical foundation to address the needs within our congregation and our community.

As before we are committed to extend deeper into personal spiritual discipleship, our growing multi-generational church family will bring more people to Christ's love and life everlasting. In doing so, we experience Him more profoundly finding connections both within ourselves and to those desperately lost and seeking answers. Our living faith is a vital blessing to a vibrant community of brothers and sisters in and outside of our facility walls.

By God's grace

we have not simply been responsive to the needs, but an example to the community as to what active engagement and collaborative partnership looks like.

Still, there is more we could do.

OUR ROADMAP

FOUNDATION OF GRACE

For the past three years, we have purposefully and prayerfully been considering where God is leading us. In 2013, we engaged in a process to revisit, reassess, and reaffirm who we are as a church today and where God wants to be in the future (Foundation of Grace). We wanted to cast a vision that would carry us forward for the next 100 years of living in community with one another, and with others.

In 2014, we developed a strategic plan that embraces **Authentic Relationships, Genuine Community, and Reflecting Christ**. We asked: How can we continue to extend our mission to our growing community?

GRACE ALIGNED

We looked at what was most important to us and articulated our core values. We asked: How are we uniquely equipped to extend into community? We brought details from various sub-committees and groups aligning our ideas and campus with mission, vision and core values. And at every step asking what God is trying to do here (Grace Aligned). We assessed how our campus, facilities, and programs are currently supporting this vision today, and how it could be improved; addressing the opportunities and constraints to help all to experience the full heart of worship and outreach.

GRACE IMAGINED

And then the board and staff began to dream—to imagine—what more we could be (Grace Imagined). That led us to three congregational priorities and a Master Site Plan to extend our ministry and impact into the community: **Corporate Worship, Children & Families, and Outreach & Youth Ministry**.

PATH TO OUR FUTURE

PHASE 1 OF THE MASTER SITE PLAN

Based on our Master Site Plan—a picture of what our campus can look like into the future, we are exploring moving forward with the following components that will have the most significant ministry expansion impact and provide the most benefit toward our greatest needs and opportunities at this stage. The decision to pursue Phase 1 will result in a campus and facilities that look similar to this image:



WE HAVE THE PASSION

AUTHENTIC RELATIONSHIPS | GENUINE COMMUNITY | REFLECTING CHRIST

PHASE 1 FLOOR PLAN RENOVATIONS

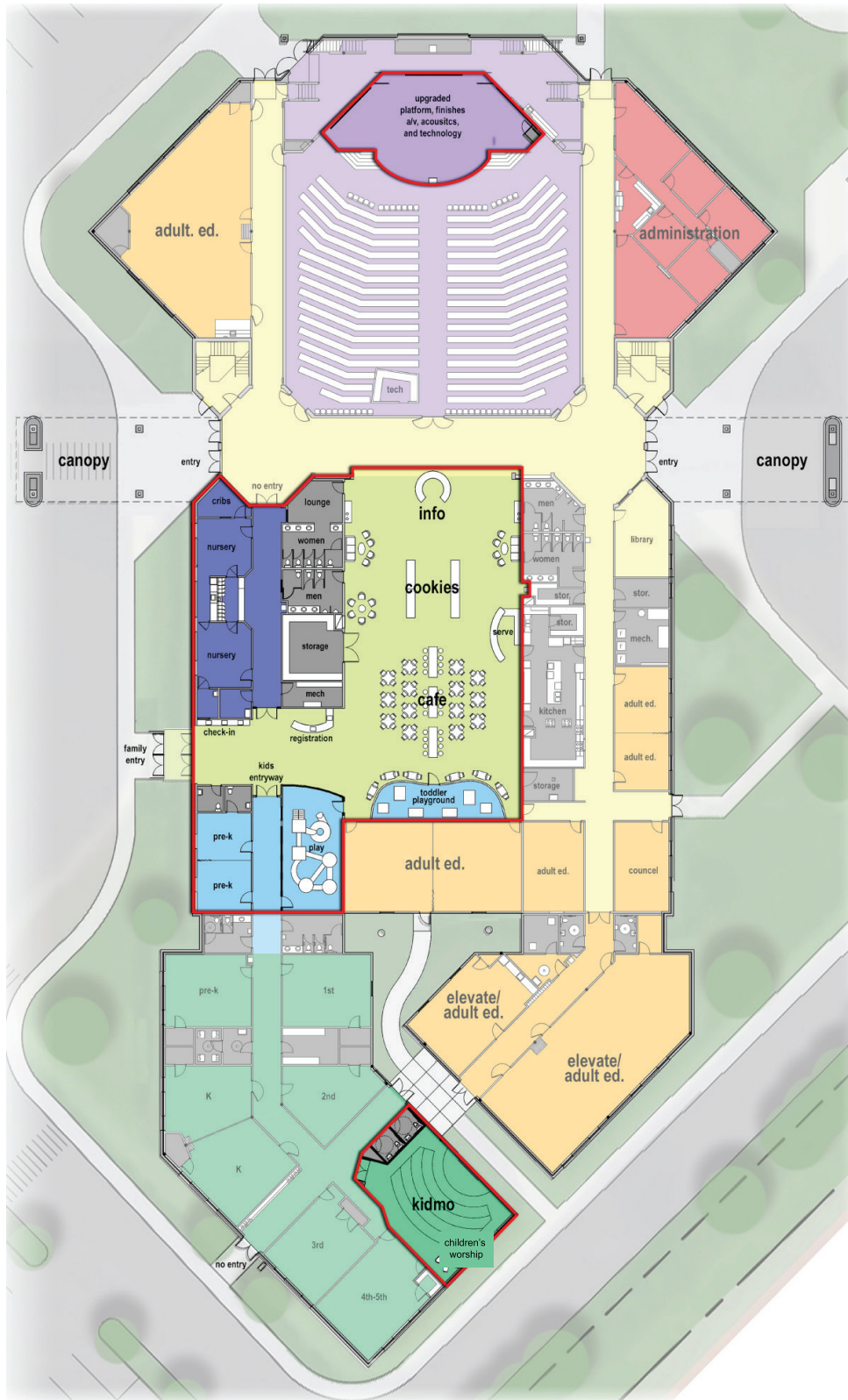

WORSHIP RENOVATIONS

Worship Center Enhancement

Audio/Visual/Acoustical Improvements & Updates.

1

HOSPITALITY

Enhanced Gathering Space

Conversion of the current gym space to provide areas for conversation and community gathering..

2

CHILDREN'S WING RENOVATIONS

For Security and Better Accommodation of Children and Family Needs.

First step of a larger vision

3



1 AUDIO/VISUAL/ACOUSTICAL IMPROVEMENTS & UPDATES

- Worship Center Enhancement:
 - Replacement of obsolete audio/video equipment.
 - Central church-wide technology coordination (not just Worship Center).
 - Provides potential to:
 - Extend digital reach (i.e. streaming services, better recording capabilities).
 - Host simulcast gatherings, concerts, and community functions.
 - Acoustical changes in Worship Center with minor structural changes.
- Enhanced technology in the classrooms (audio/video streaming of teaching resources).

2 ENHANCED GATHERING SPACE CONVERSION OF CURRENT GYM SPACE

- Creates area for hospitality and fellowship—a place to linger and connect with others.
- Flexible, inviting gathering spaces for conversation, convening, and community.
- Allows seating and arrangements for small or large group engagement (i.e. cafe style or for large banquets up to 340 people).
- Dedicated coffee service facility.
- Increased and varied opportunities for Monday-Saturday usage (i.e. life groups, social, or discipleship uses).

3 CHILDREN'S WING RENOVATION FOR SECURITY & EXPANSION

- New, enhanced, and streamlined family entrance.
- Providing increased security and safety for our children.
- Providing peace of mind for parents.
- Better line of sight drop-off and pick-up.
- Potential to increase classroom space.

WE HAVE THE VISION

AUTHENTIC RELATIONSHIPS | GENUINE COMMUNITY | REFLECTING CHRIST

PHASE 1 NEW CONSTRUCTION FAMILY LIFE CENTER & MULTI-USE FACILITY



FAMILY LIFE CENTER

New Construction, Stand Alone Building

Building on the south side of campus, angles towards current building, sidewalk connection from current building, accessible by a new entrance from Whistlestop Road; a visual invitation to the community.

4

CAPITAL REPLACEMENT PLANNING Fund

Expand a fund for capital replacement of existing facility and structures (i.e. roof, HVAC, parking lots, etc.)

Ten percent (10%) of all funds raised would be set aside for these needs to ensure upkeep of our aging, and well-used facility.

5

4 FAMILY LIFE CENTER MULTI-USE FACILITY

- Allows for growth, teaching, and worship space.
- A solution to future growth with a 200 seat on-site satellite venue.
- Ten breakout rooms that could be consolidated to five larger gathering spaces.
- Includes lobby, game zone, cafe area, and additional kitchen facility.
- Provides opportunities for new ministries:
 - RCBC programs and ministries—new ministries our church initiates.
 - Additional community-initiated programming—ministries throughout our community.
 - Facility rental.
- Frees up the existing church building for increased and varied usage.
- Allows renovation of current gym for hospitality and an inviting place for conversation.
- Provides additional creative opportunities for children and youth ministry:
 - During the week (i.e. AWANA).
 - Optimal DropZone venue and related ministry growth.
 - Other programs we currently are unable to offer due to the constraints of timing or conducive space.
- 2nd hour youth programming.



FUNDING OUR FUTURE

The preliminary costs for implementation of these first proposed components—Phase 1 of the Master Site Plan—may range between \$4.5M-\$5.5M. If we as a congregation support this direction, it would be our intent to move forward with a capital stewardship campaign in the Fall of 2017.

We would ask for 100% participation from the full congregation to make a pledge/commitment, which may be payable over three years, in addition to their annual giving. We would ask that each household consider an individual response based upon our individual blessings.

Not Equal Gifts, But Equal Sacrifice

GRACE ALIVE

The next step in our process is a feasibility study. Our leadership is seeking input from all of you for continued response, review, and refinement as well as the level at which our church family agrees and is willing to support the proposed ministry expansion plans.

God has been using this church in amazing ways. And He is not done with us yet. We are extremely excited about what the future holds, and we remain committed to listening for His leading.

For nearly 100 years, God has been guiding us on this path. We find vivid examples of His faithfulness strewn throughout our history, but most especially when we have taken extremely bold steps of faith at His urging.

That's ministry expansion—growing into the lives of the people around us. That's bold Christianity—offering something and Someone that is counter-culture.

As we move forward together, consider how God's grace will be vibrantly extended through you.

BETTER MEETING THE CHANGING NEEDS TODAY...
ANTICIPATING THE GROWING NEEDS OF TOMORROW.

These renderings paint a picture of what could be, they are not a statement of what will be. Much more prayer, consideration, and planning will determine the shape of the final renovations.

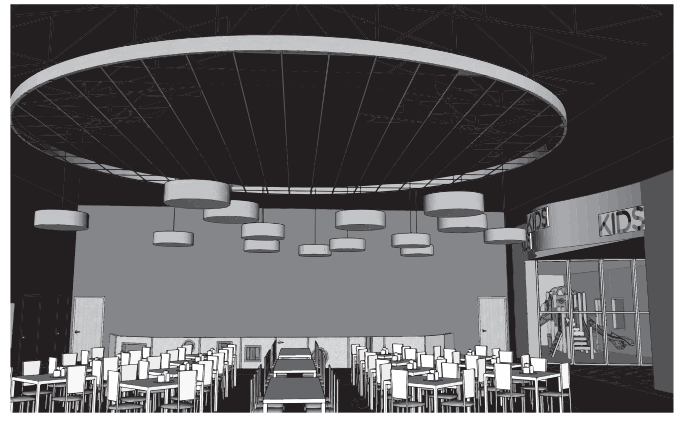

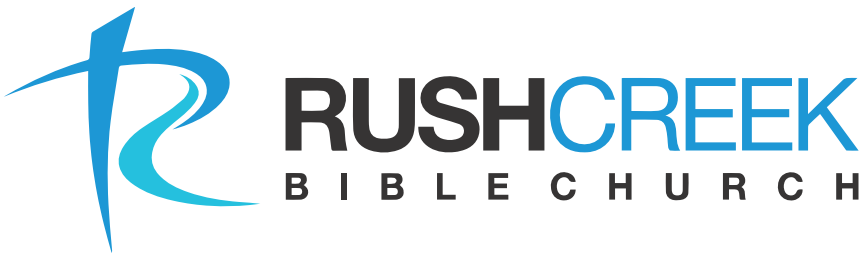

Renderings
designed by:

elevate studio
architecture · design